



ART. M8228

Bullone occhio con anello, **AISI304-AISI316**

Ring bolts with shoulder, **AISI304 - AISI316**

Codice Articolo Item Number	A2 A2	Codice Articolo Item Number	A4 A4	D	D1 (mm)	L (mm)	T (mm)	W (mm)	Carico di lavoro (Kg) working Load (Kg)	Carico rottura (Kg) Breaking Load (Kg)	 Box	 Master carton	 Pallet
M8228-2-6		M8228-4-6		M6	6	90	55	35	80	700	10	150	6000
M8228-2-8		M8228-4-8		M8	8	100	60	45	150	1240	10	100	4000
M8228-2-10		M8228-4-10		M10	9	130	80	50	300	1940	10	40	1600
M8228-2-12		M8228-4-12		M12	12	150	90	60	400	2780	10	20	800

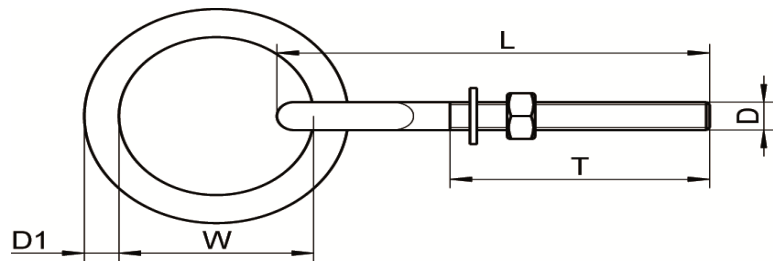

Attenzione!!! Nessuno dei prodotti presenti in questa sezione soddisfa i requisiti per l'utilizzo in apparecchiature di sollevamento, imbracature o mezzi di sostegno carichi (Direttiva 2006/42/CE), né possiede la conformità che certifica la verifica dei requisiti della norma tecnica EN 795:2012 (Linee vita classi A, C e D Norma UNI 11578:2015), né la marcatura CE (es. Linee vita classi B e E). Le caratteristiche tecniche sopra riportate, sono puramente indicative e possono subire variazioni da lotto a lotto, a seconda della produzione.

*Pay attention!! None of our products have been developed or manufactured for lifting equipment, slings or load support devices (Directive 2006/42/EC). As for the fall protection systems, our products do not have the conformity certifying the verification of the requirements of the technical standard EN 795:2012 (fall protection systems Class A, C and D) and do not have the CE marking (eg. fall protection systems Class B and E). The technical data of these items are merely indicative.*

*They can undergo minimal changes from batch to batch according to the production.*

last edit 04/10/2021

DRAWING N. 1201